



Ear Clamp

This clamp was designed for use in assembly lines due to the fast and easy locking system. It is normally mounted where a fixed diameter clamp is required and the application zone is difficult to access.

It is particularly useful in low to medium pressure applications and for air transfer.

Once this clamp has been mounted it is tamper-proof.

* This clamp is also available in W4 (AISI 304 stainless steel) material upon request.

W1

Ear Clamp W1

Nominal \emptyset $D \pm 0,3$ mm.	Closed \emptyset D min.	Part n° W1	H max. mm.	S $\pm 0,3$ mm.	a $\pm 0,15$	Box Quantity (MOQ)	Packing
10,0	8,3	03030752	14,0	0,6	7	1000	8000
13,3	10,8	03030760	17,0	0,6	7	1000	8000
15,7	13,2	03030779	20,1	0,6	7	1000	5000
17,5	14,3	03030787	22,5	0,8	7	1000	5000
17,8	14,6	03030795	22,5	0,8	7	1000	5000
18,5	15,3	03030808	23,5	0,8	7	1000	4000
20,5	17,3	03030816	26,0	0,8	7	500	3000
29,5	26,3	03030824	35,5	0,8	7	500	3000
31,6	28,4	03030832	37,5	0,8	7	500	2000
39,6	36,4	03030840	45,5	0,8	7	500	2000
40,5	37,3	03030859	46,5	0,8	7	500	1000
45,5	42,3	03030867	51,5	0,8	7	200	400
47,0	43,8	03030875	53,0	0,8	7	200	400
51,5	48,3	03030883	57,5	0,8	7	100	500
52,5	49,3	03030891	58,5	0,8	7	100	500
65,5	62,3	03030904	71,5	0,8	7	100	500

W1 Band: Mild Steel Dx51D + AZ 150 (UNI EN 10215)

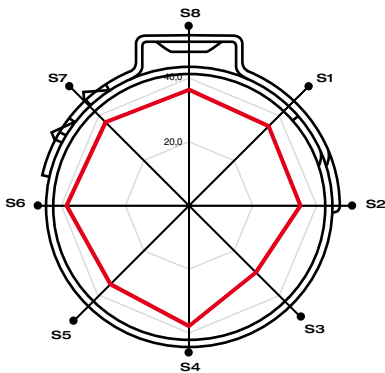

Polar Diagram

● Sectors	S1	S2	S3	S4	S5	S6	S7	S8
— Force Kg	35,3	35,0	29,6	37,8	34,9	38,5	36,4	37,1

Torque / Efficiency [Nm / daN]

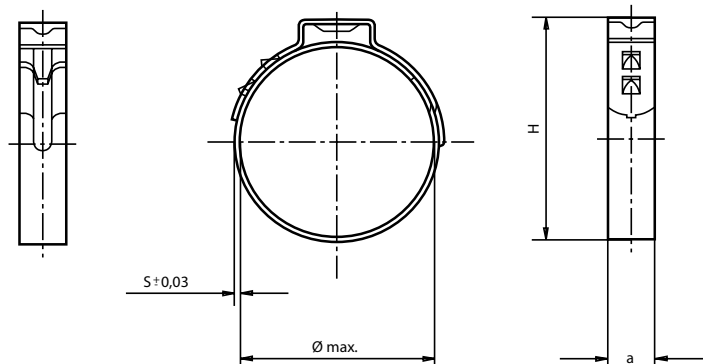



info@iq-parts.nl
Harsweg 34A
2461 EZ Ter Aar
T +31 252 624 126
The Netherlands