

iQ parts
IQ-PARTS-SHOP.COM



**SPECS &
INFORMATION**

Recommended Tightening Torque

Thread Size	Nylon 66		PP		PVDF	
	Nm	ft lb	Nm	ft lb	Nm	ft lb
1/8"	0.1	0.07	0.01	0.01	0.1	0.07
1/4"	0.8	0.6	0.3	0.2	1	0.8
3/8"	4	3	1	1	5	3
1/2"	6	4	2	2	8	6
3/4"	8	6	5	4	16	12
1"	10	7	8	6	26	19

Fittings Tolerances (According to ISO 2768-c)

Size mm	Tolerance
1-6	±0.3
6-30	±0.5
30-120	±0.8

Chemical Resistance

	Water		Acids		Detergents	
	Cold	Hot	Weak	Strong	Weak	Strong
LDPE	3	1	3	2	3	3
HDPE	3	3	3	3	3	3
Nylon 6-6	3	2	1	1	3	2
Polypropylene	3	3	3	2	3	3
Acetal	3	3	2	1	3	3
PVDF	3	3	3	3	3	3

1 - Bad 2 - Medium 3 - Good

Note:

Notice tube dimension differ between industries.

Fittings' dimensions refer to tube ID or OD, with respect to the common application.

Use thread seal tape



Minimum straight tube segment



PROPERTIES

Yield stress of PP as a function of temperature

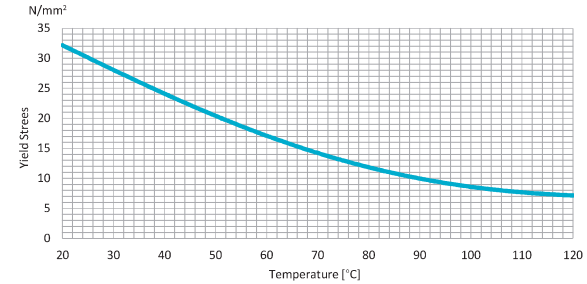

Flexural modulus VS. temperature

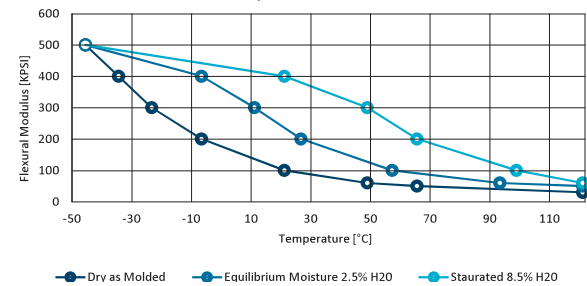

Flexural modulus VS. moisture content at 73 °F

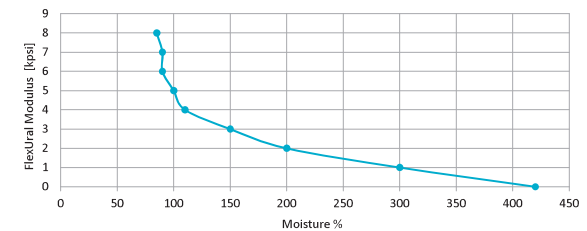

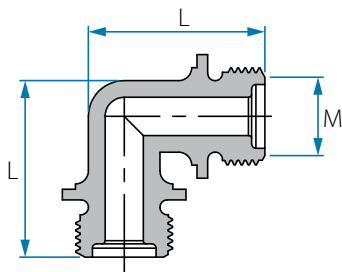

BSPT Threaded Elbow

Cat. No.	M (BSPT)	L mm	Color
12016502008	1/8"	24.4	● Blue
12016504008	1/4"	26.4	● Blue
12016506008	3/8"	31.8	
12016508008	1/2"	40.2	
12016502002	1/8"	24.4	● Black
12016504001	1/4"	26.4	○ White
12016504002	1/4"	26.4	● Black

Note: Packing 25 unit

NPT Threaded Elbow

Cat. No.	M (NPT)	L mm	Color
12026502003	1/8"	23.8	● Grey
12026504003	1/4"	28.4	● Grey

Note: Packing 25 unit

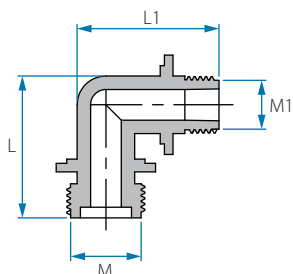

BSPT Reducing Threaded Elbow

Cat. No.	M (BSPT)	M1 (BSPT)	L mm	L1 mm	Color
12016904028	1/4"	1/8"	26.4	24.4	● Blue
12016906048	3/8"	1/4"	31.8	31.5	
12016908068	1/2"	3/8"	40.0	38.1	

Note: Packing 25 unit

NPT Reducing Threaded Elbow

Cat. No.	M (NPT)	M1 (NPT)	L mm	L1 mm	Color
12026904023	1/4"	1/8"	28.4	24.0	● Grey

Note: Packing 25 unit



info@iq-parts.nl
Harsweg 34A
2461 EZ Ter Aar
T +31 252 624 126
The Netherlands