

iQ parts
IQ-PARTS-SHOP.COM



**SPECS &
INFORMATION**

Angebotszeichnung
QUOTATION DRAWING

Teil-Nr ITEM-NO	Stueck QTY	Benennung PART - NAME	Werkstoff MATERIAL	Oberflaeche SURFACE
1	1	NORMAQUICK PS3-VDA NW8	PA66-GF30	black
2	1	Weld ring NW8	PA66-GF30	black
3	1	Locking bail NW8	EN 10270-3-1.4310-NS-1.2	black
4	1	O-RING 12.0 X 3.0	EPDM-70	black

SCHNITT / SECTION A-A

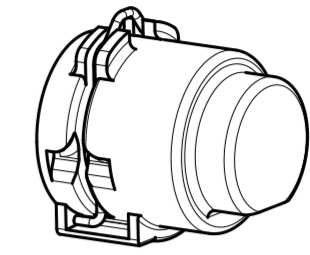
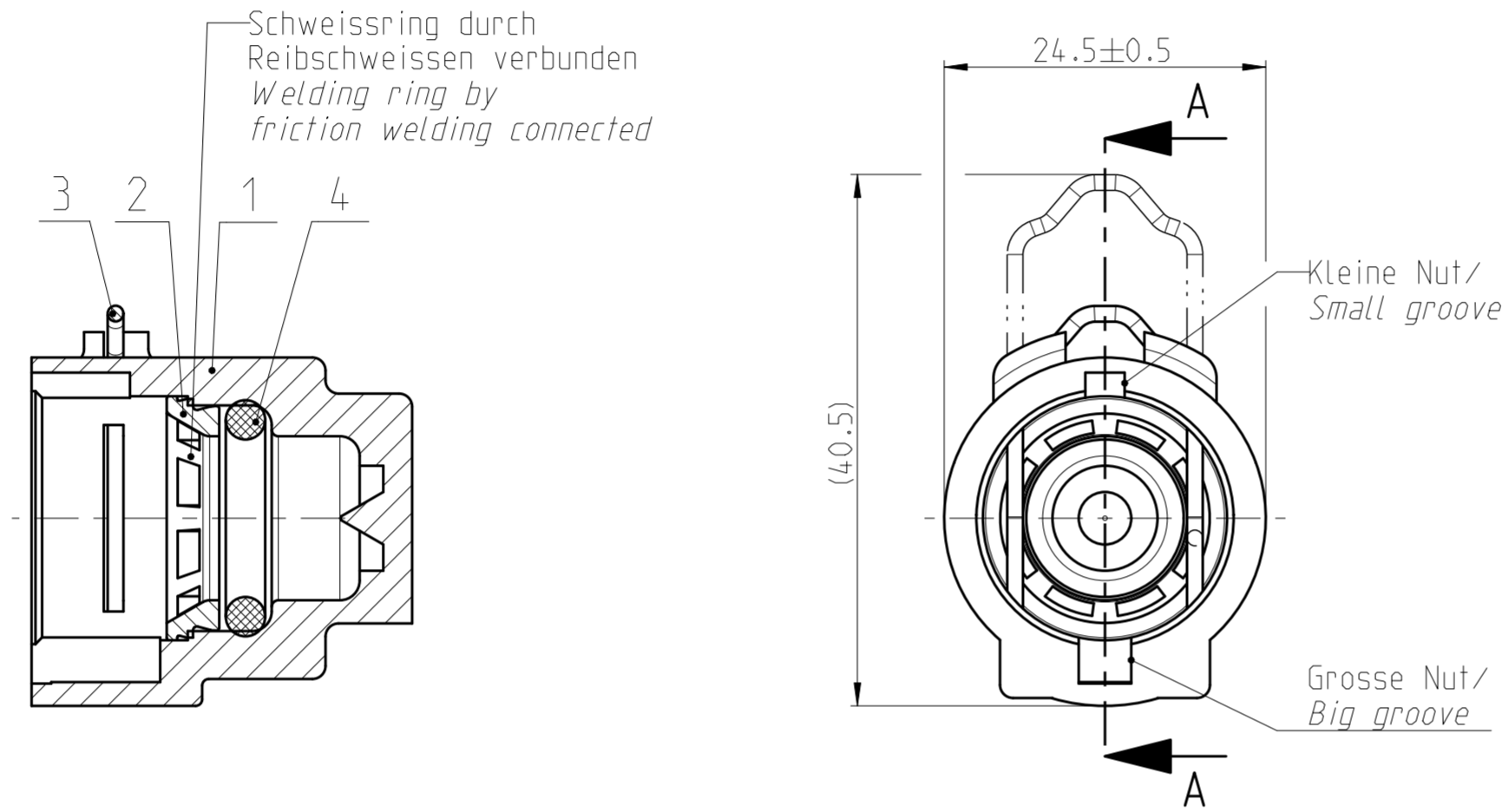

MASSTAB / SCALE 1:1

Ansicht Stutzen / View spigot
MASSTAB / SCALE 2:1

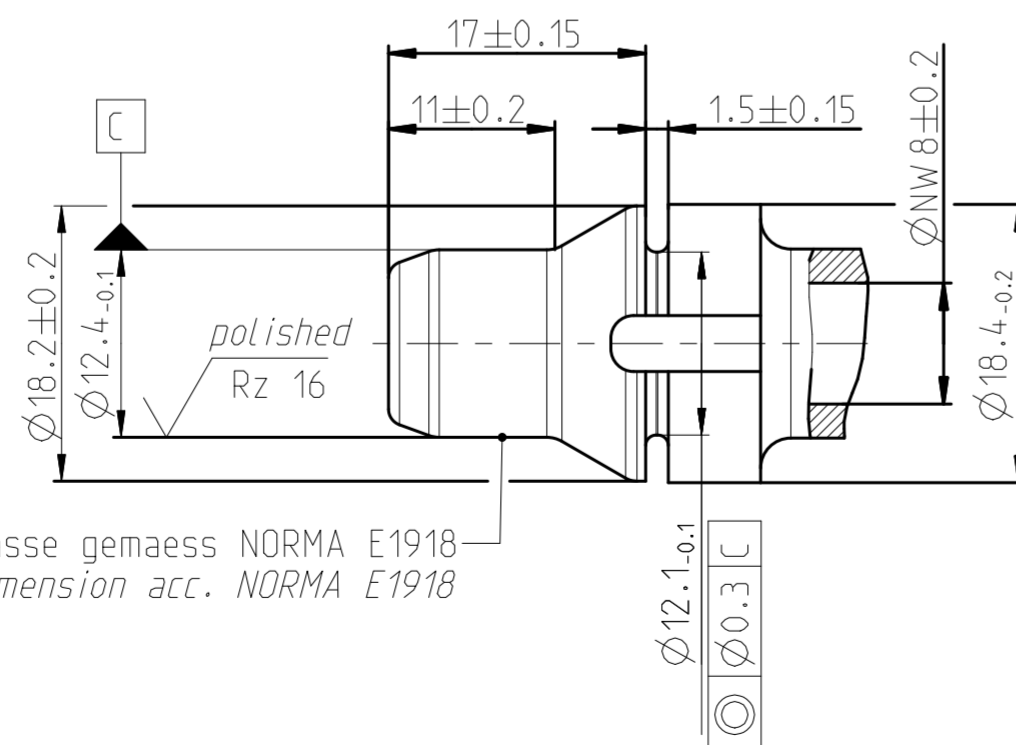

Performance features for NQ PS3 - VDA	
Medium	coolant water
Operation temperature	-40°C thru 135°C, short-term up to 150°C (max. 30 min. over Lifetime)
Operation pressure	0 to 2 bar, partial pulsating (sinusoidal)

NORMAQUICK - ASSEMBLY MARKING	
Customer part-No.:	-
Trademark:	-
Manufacturer code:	NORMA-RSS
NORMA date code:	XX YY
Material code molding part:	>PA66-GF30<

INDEX Teil/ PART	Anz. Zeichn/ DWG	Anz. QTY.	Aenderung DESCRIPTION	Aend.Nr. CHANGE-NO.	Datum DATE	Bearb. DRAWN	Gepr. CHECKED
-	-	-	-	-	-	-	-
-	-	-	-	-	-	-	-
-	-	-	-	-	-	-	-
-	-	-	-	-	-	-	-
-	-	-	-	-	-	-	-
Allgemeintoleranz: GENERAL TOLERANCE:		Form- und Lagetoleranz: FORM AND POS. TOL.:	Abmass fuer Winkel: DEVIATION FOR ANGLE:	Gewicht / WEIGHT: errechnet / gewogen CALCULATED / actual	Volumen: VOLUME:	Pruefkennzeichnung: TEST MARKING:	
-		-	-	-	- cm ³	-	
Projektions-Methode 1 1st ANGLE PROJECTION DIN ISO 128-30		Material: see parts list	PART NAME: NORMAQUICK PS3-VDA NW8-0° Blind plug				
NORMA-Patentnummer: PATENT NUMBER:		Material-No.: - Oberflaeche: see parts list SURF. QUAL.: -	Benennung: NORMAQUICK PS3-VDA NW8-0° Blindstopfen				
Bandlaenge: LENGTH OF BAND:		Massstab: SCALE: 2:1	Datum/DATE 2013-11-25	Name/NAME Schindler	Kunde / CUSTOMER:		
ZNE:		Gepr./CHECKED 2013-11-25	Norm	-	Zeichnungs-Nr./DRAWING-NO.:		
Ursprung/Anfrage: ENQUIRY-NO.:		Schutzvermerk nach ISO 16016 beachten CONSIDER AFTER PROTECTION NOTICE ISO 16016		NORMA Germany GmbH Postfach 1149 • 63461 Maintal		0702 8706 008	
9900022929-001		© COPYRIGHT BY NORMA Group		SUB.F.: -		SUB.FROM: -	
CAD-SYSTEM Pro/Engineer		DRAWING-NAME: 07028706008_Q		MODEL-NAME: 07028706008		MODEL-TYP: ASSEM	



info@iq-parts.nl
Harsweg 34A
2461 EZ Ter Aar
T +31 252 624 126
The Netherlands