

iQ parts
IQ-PARTS-SHOP.COM



**SPECS &
INFORMATION**

ITEM NO.	QTY.	PART NUMBER	DESCRIPTION	COLOR
1	1	HS327	HOUSING	BLACK
2	2	OR114N	O-RING	BLACK
3	1	MS003	SPACER	NATURAL
4	1	PS009	BUSHING	BLACK
5	1	RE019	RETAINER	GRAY

REVISION RECORD				
REV.	DESCRIPTION	DATE	DRW	APP.
A	RELEASED	1/26/2010	DMF	MRB
B	MATERIAL: PA66 GF30 PER SAE-J1639-1165 WAS PA66 GF33 PER SAE-J1639-1166 ECR 11-0008	8/31/2011	DMF	MRB
C	ADDED BUSHING MATERIAL: NYLON 66, 30% GLASS FILLED PER SAE-J1639-PA1165 ECR 12-0013 PROJ. P-3611	4/18/2012	DMF	MRB

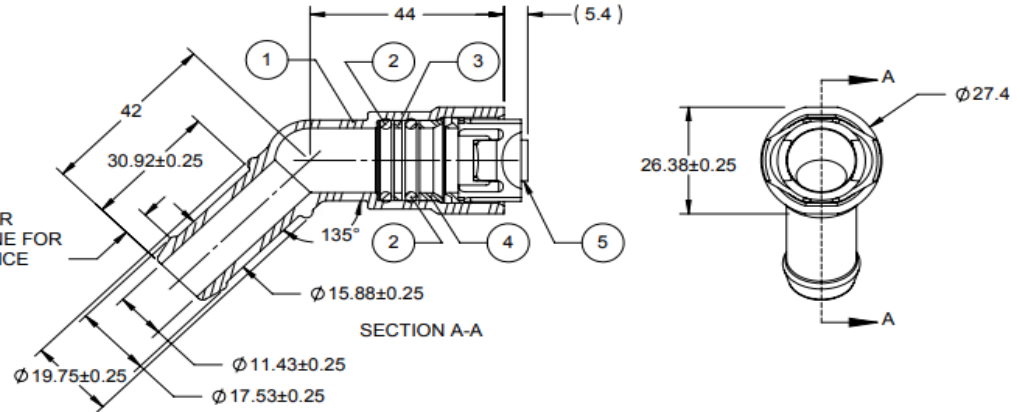

MATERIAL:
HOUSING: NYLON 66 30% GLASS FILLED SAE-J1639-PA1165
O-RING: SAE J200M-3DA-710-A26-B36-C32-EA14-F19-Z1 Z2 Z3
Z1 - PEROXIDE CURED EPDM
Z2 - DUROMETER: SHORE A 60-75
Z3 - INTERNALLY LUBRICATED
SPACER: NYLON 612 ASTM D4066-PA0621
RETAINER: NYLON 612 ASTM D4066-PA0621
BUSHING: NYLON 66, 30% GLASS FILLED PER SAE-J1639-PA1165
BUSHING OPTIONAL: NYLON 12 23% GLASS FILLED
PER ASTM D4000-PA420G23A99690CD178GA116
JR110AA002KB090MA115UA34YD160

- 1) LUBE O-RINGS WITH DOW CORNING 200 SILICONE PRIOR TO ASSEMBLY
- 2) ASSEMBLY PLANT INSTRUCTIONS MUST SPECIFY:
 - A) INSERT TUBE INTO CONNECTOR UNTIL AN AUDIBLE CLICK IS HEARD AND/OR RESISTANCE TO FURTHER INSERTION SIGNIFICANTLY INCREASES.
 - B) PULL BACK ON THE TUBE IN THE OPPOSITE DIRECTION OF INSERTION WITH A MINIMUM OF 15 LBS. FORCE TO INSURE THE TUBE IS PROPERLY LATCHED
- 3) MARK HOUSING PER SAE-J1344
- 4) MATERIAL CONTROL PER GM 1000M OR ESA-M99P23-A

PROPRIETARY INFORMATION NOTICE
THIS DRAWING HAS BEEN CREATED BY CRAIG ASSEMBLY, INC. (C.A.I.) AND THE INFORMATION CONTAINED HEREIN IS BOTH CONFIDENTIAL AND PROPRIETARY AND CANNOT BE USED UNLESS SPECIFICALLY AUTHORIZED IN WRITING BY C.A.I. THE RECIPIER OF THIS DOCUMENT, BY ITS RETENTION AND USE, AGREES TO HOLD THIS DOCUMENT AND ITS CONTENTS IN STRICT CONFIDENCE AND TO PROTECT THE SAME FROM LOSS, THEFT OR UNAUTHORIZED USE. THIS DRAWING SHALL NOT BE COPIED OR COMMUNICATED TO ANY THIRD PARTY, IN WHOLE OR IN PART BY ANY MEANS, WITHOUT THE PRIOR WRITTEN CONSENT OF C.A.I. THIS PROPRIETARY INFORMATION NOTICE IS AN INTEGRAL PART OF THIS DRAWING AND SHALL NOT BE REMOVED OR ALTERED.

UNLESS OTHERWISE SPECIFIED: DIMENSIONS ARE IN MM TOLERANCES: X ± .5MM X ± .25MM X ± .13MM ANGULAR: ±2 DEG.	NAME DMF	DATE 01/26/10	
GEOMETRIC TOLERANCING PER: ASME Y14.5M 1994	CHECKED		
MATERIAL: NOTED	ENG APPR.		TITLE: 5/8 X 135° 5/8 HOSE BARB CONNECTOR ASSEMBLY
PROJECT: DO NOT SCALE DRAWING	MFG APPR.		SIZE B
	Q.A.		PART NO. 10EPA10013
	<input checked="" type="checkbox"/> CRITICAL - SPC REQ'D <input type="checkbox"/> FIT/FUNCTION <input type="checkbox"/> CERTIFY FROM TOOLING	DWG. NO. 10EPA10013	REV C
		SCALE: 1:1	WEIGHT:
			SHEET 1 OF 1



info@iq-parts.nl
Harsweg 34A
2461 EZ Ter Aar
T +31 252 624 126
The Netherlands