

**iQ parts**  
IQ-PARTS-SHOP.COM



**SPECS &  
INFORMATION**

QUOTATION DRAWING

\*Alternativ Werkstoff: 11SMnPb37  
 \*Alternative material: 11SMnPb37

Teil-Nr. ITEM-NO.	Stueck QTY.	Benennung PART - NAME	Werkstoff MATERIAL	Oberflaeche SURFACE
1	2	Schellenband (Bd. 1.29x25xL) Band (Bd. 1.29x25xL)	S320GD+Z275MA	siehe Text see notes
2	2	Schellenband (Bd. 1.29x25xL) Band (Bd. 1.29x25xL)	S320GD+Z275MA	
3	2	Bruecke Bridge	DC 03 C390	
4	4	Stuetzwinkel Support angle	DC 01 C390	
* 5	2	Fuehrungsbuechse M10 Guide bushing M10	11SMnPb30	
* 6	2	Gewindebuechse M10 Threaded bushing M10	11SMnPb30	
7	2	Sechskantschraube ISO 4017 - M10x45 - 8.8 Hexagon Head Screw ISO 4017 - M10x45 - 8.8	8.8	

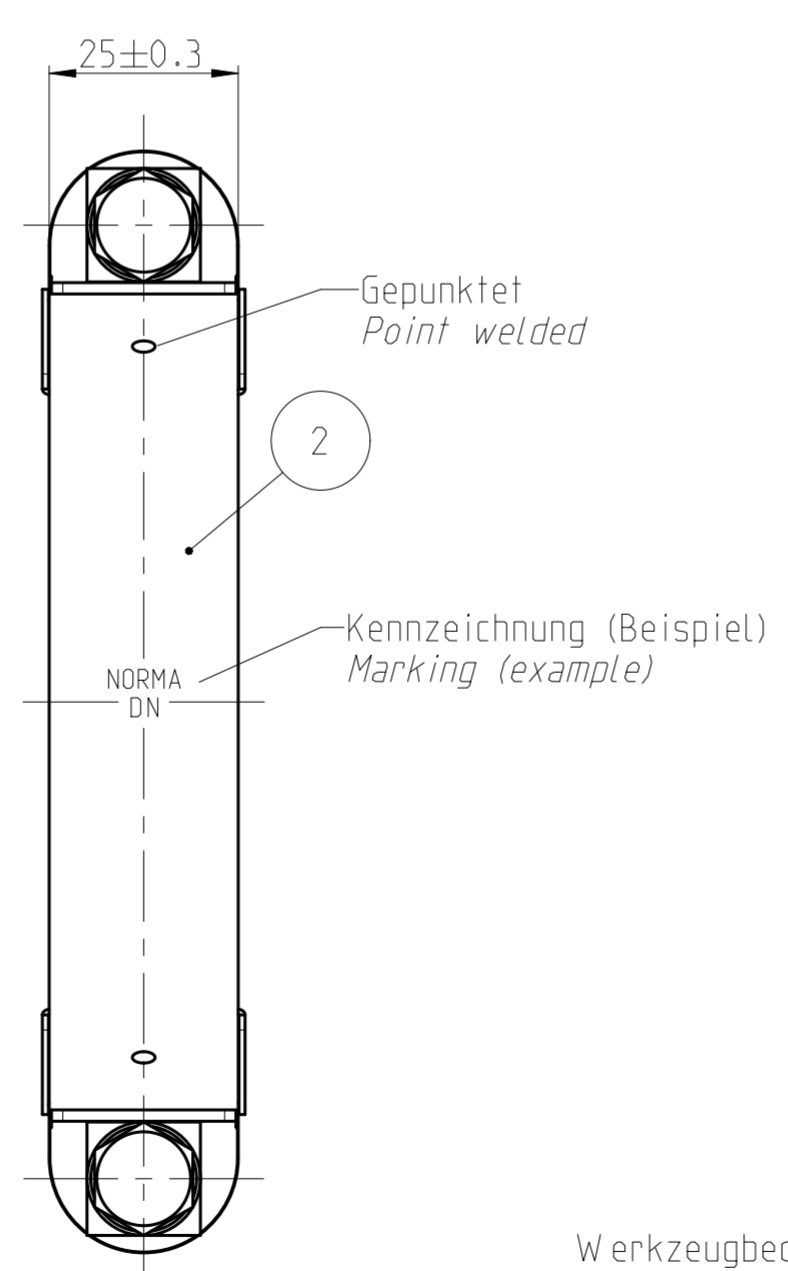
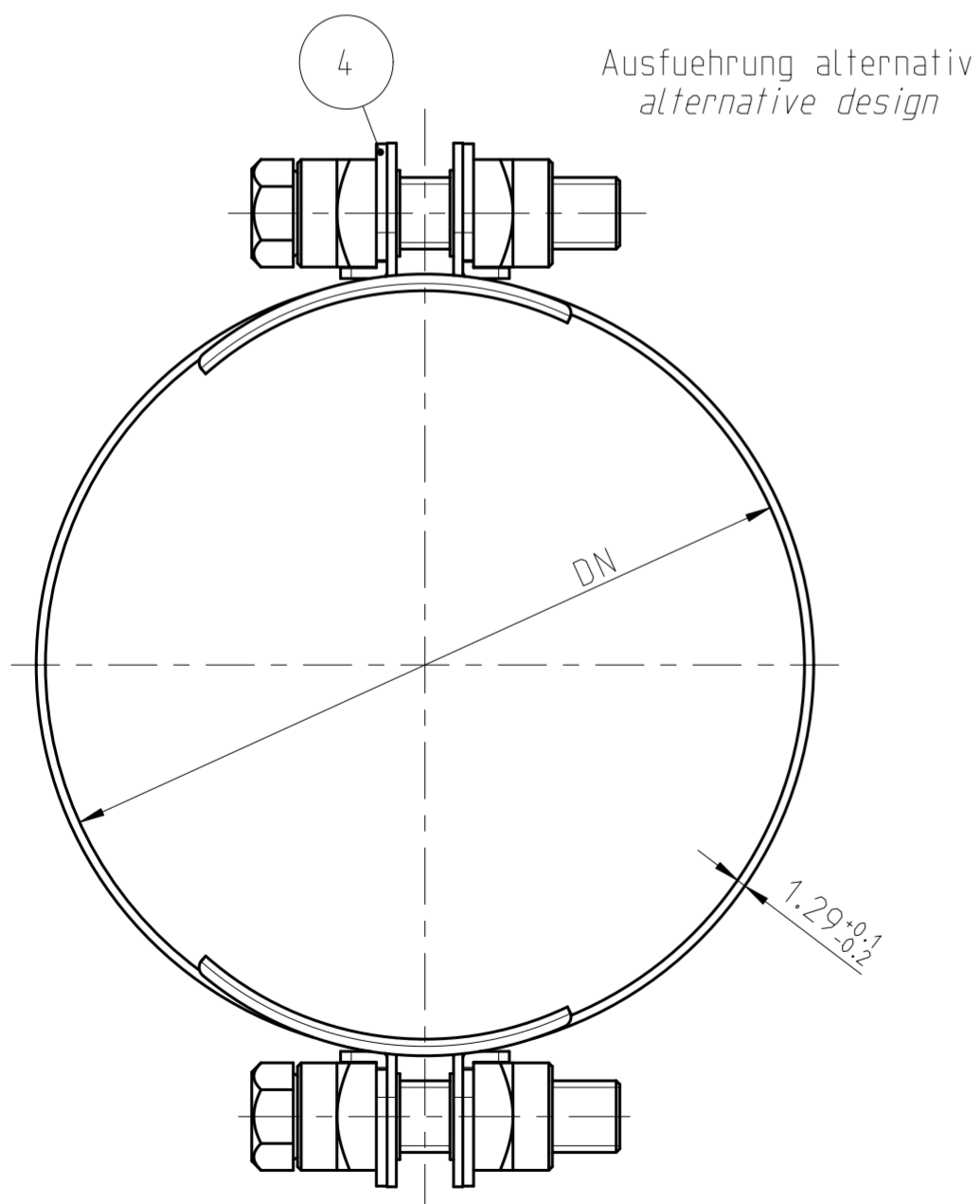
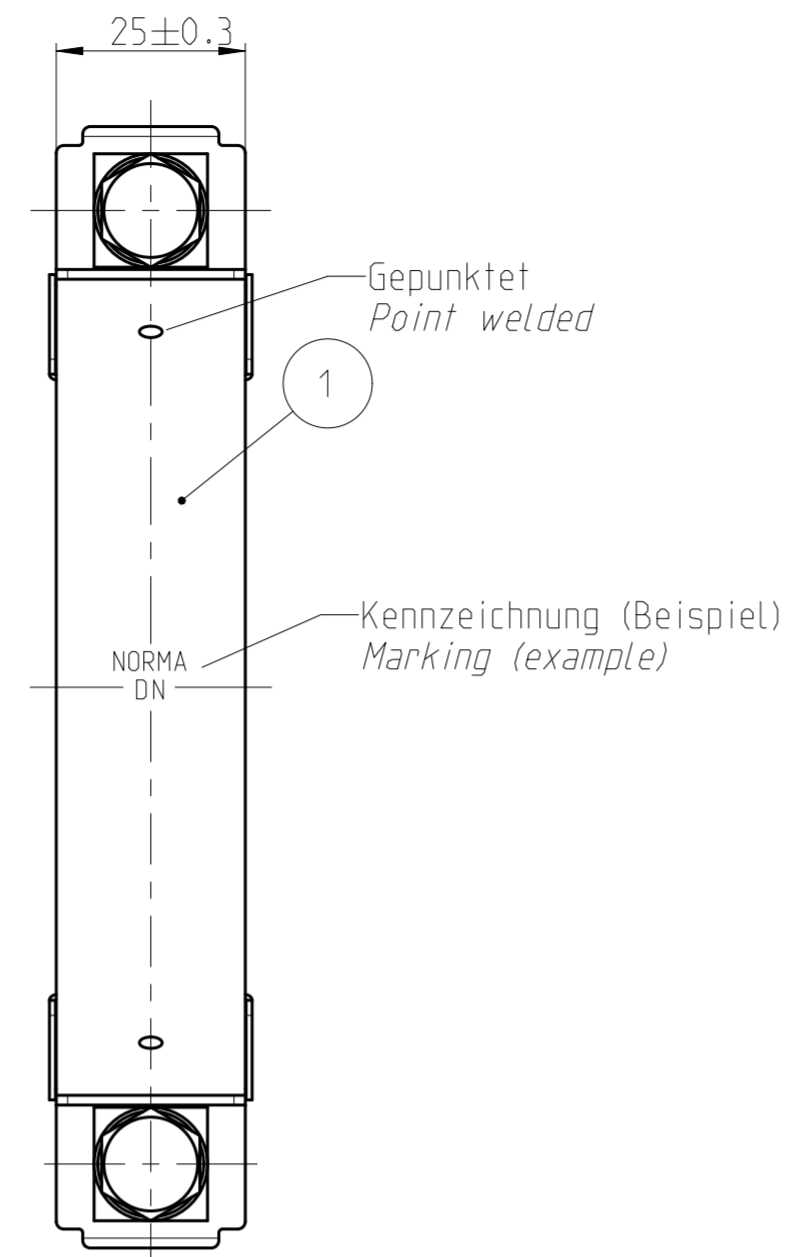
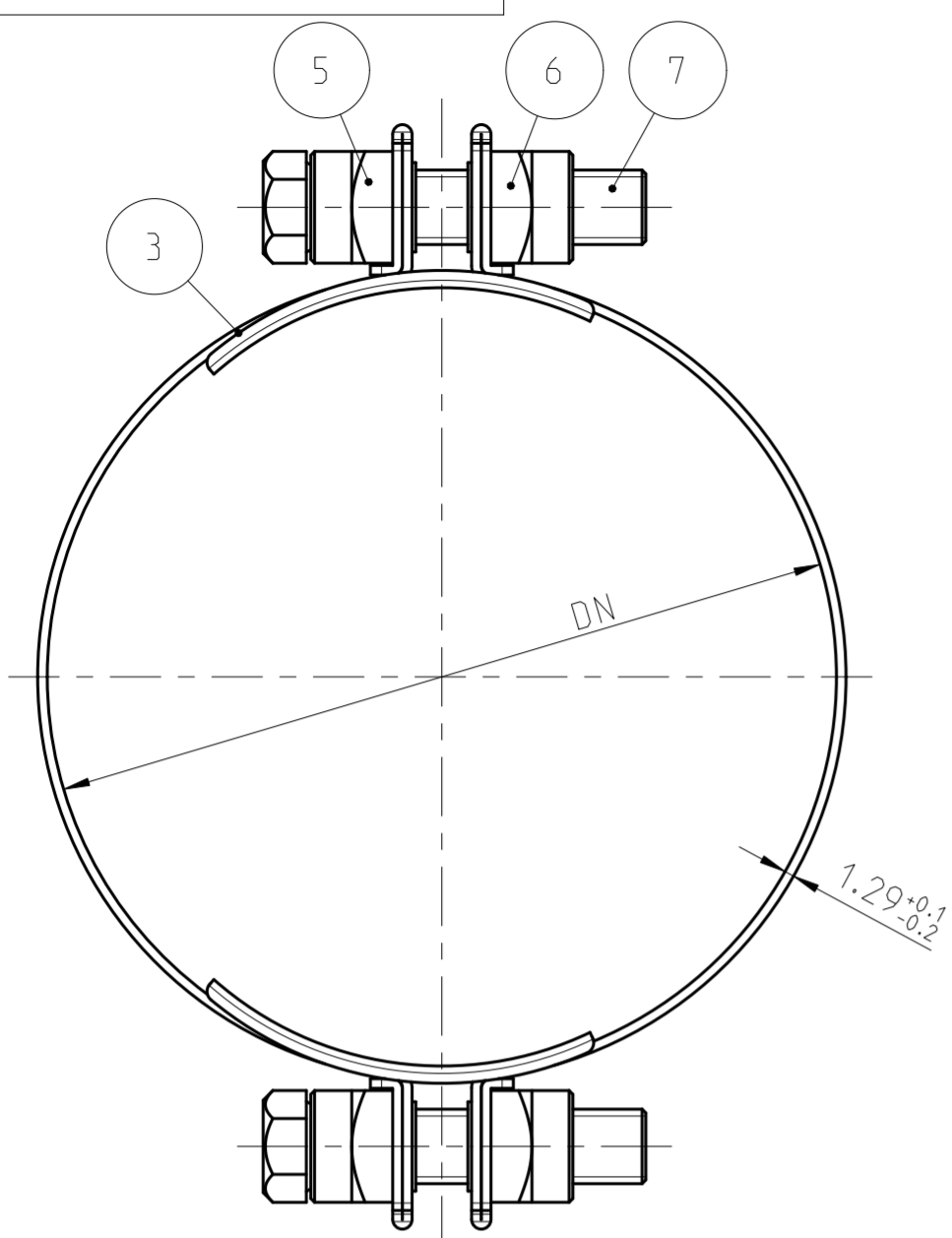

Durchmesserangabe  
 Beispiel: 0160 0020 120  
 fuer Durchmesser DN=120 mm

Teilenummer: 0160 0020 000

"DN" Schlauchaußendurchmesser

The clamp will be produced in 2mm steps.  
 Smallest clamp diameter = 46 mm  
 Clamp from clamp diameter = 301 mm delivered not bended  
 Order marking: S DN/25 W1 2-parts

diameter declaration  
 example: 0160 0020 120  
 for diameter DN=120 mm

Part-no.: 0160 0020 000

"DN" pipe-outside-diameter

Anlieferzustand: Schraube bis Gewindebuechsenende eingeschraubt,  
 ±2 Gewindegaenge

Delivery condition: to screw in threaded bushing completely,  
 ±2 thread

Oberflaeche:  
 Teil 1 und 2: verzinkt nach DIN EN 10346  
 Teil 3, 4, 5 und 6:  
 verzinkt nach EN ISO 2081 Fe/Zn 8 B  
 Teil 7: verzinkt nach VW OFL C 34 10-12 microns

Surface:  
 Part 1 and 2: zinc plated to DIN EN 10346  
 Part 3, 4, 5 und 6:  
 zinc plated acc. to EN ISO 2081 Fe/Zn 8 B  
 Part 7: zinc plated acc. to VW - OFL C 34 10-12 microns

Werkzeugbedingte geringfuegige Beeintraechtigung  
 der Oberflaeche beim Komplettieren der Schelle  
 kann nicht ausgeschlossen werden !

The tool may cause exceptional minimal superficial  
 flaws during the assembly of the clamp!

GENERAL TOLERANCE:	DIN 6930-m
FORM AND POS. TOL.:	DIN ISO 2768-K
DEVIATION FOR ANGLE:	-

INDEX PART	DWG	QTY	REVISION SUMMARY	CHANGE-NO	DATE	DRAWN	CHECKED
-	-	-	-	-	-	-	-
-	B	2	Surface norm updated, Alternative material for bushings added	-	2020-12-08	M.POLENKA	L.POLASEK
-	A	2	English notes and table were added	01-612952	2015-12-09	Holik	Oplusfil

1st ANGLE PROJECTION	ACCORDING TO: DIN EN ISO 1101	PART NAME:
	SCALE: DATE: YYYY-MM-DD NAME	NORMACLAMP
	1:1 DRAWN: 1998-02-01 Loehr	Pipe-clamp acc. to DIN 3017-2
	MM [CHECKED] - JGY	S DN/25 W1 2-part
PROJECT-NO.: 9900010000-013F	NORMA Germany GmbH Postfach 1149 63461 Maintal	CUSTOMER:
CAD-SYSTEM: Creo 3.0 M140	(C) COPYRIGHT NORMA GROUP DIN ISO 16016	CUSTOMER-NO:
DRAWING-NAME: 01600020000_0		NORMA-NO: 0160 0020 000
		PART INDEX DWG TYPE FORMAT SHEET
		- B Q A2 1/1





info@iq-parts.nl  
Harsweg 34A  
2461 EZ Ter Aar  
T +31 252 624 126  
The Netherlands