

iQ parts
IQ-PARTS-SHOP.COM

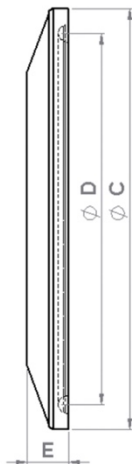

**SPECS &
INFORMATION**

Blanks DIN32676 sched. A/B/C
Material: AISI 316L (1.4404)
Surface acc. To Hygiene Class H3
Inside: <0,8 µm, Outside: <1,6 µm



For Flange ϕ In mm	Tube size / Nominal Size			C mm	D mm	E mm	Item-No.
	DIN 32676 Sched.C / ISO 2852 ASME BPE	DIN 32676 Sched.B / ISO 1127	DIN 32676 Sched.A				
25,0	¼"-¾"	NW 10,2-17,2	06-08	25,0	20,2	4,75	20411000
34,0			10-15-20	34,0	27,5	6,35	20411050
50,5	1"-1½"	NW 21,3-33,7	25-32-40	50,5	43,5	6,35	20411100
64,0	2"	NW 42,4-48,3	50	64,0	56,5	6,35	20411150
77,5	2½"	NW 60,3		77,5	70,5	6,35	20411200
91,0	3"	NW 76,1	65	91,0	83,5	6,35	20411250
106,0	3½"	NW 88,9	80	106,0	97,0	6,35	20411300
119,0	4"		100	119,0	110,0	8,0	20411400
130,0		NW 114,3		130,0	122,0	8,0	20411450
144,4	5"			144,4	134,4	10,0	20411500
155,0		NW 139,7	125	155,0	146,0	8,0	20411550
167,0	6"			167,0	156,5	14,0	20411600
183,0		NW 168,3	150	183,0	174,0	14,0	20411650
217,4	8"			217,4	207,4	14,0	20411700
233,5	8¾"	NW 219,1	200	233,5	225,0	14,0	20411750
268,0	10"		250	268,0	258,0	14,0	20411800
286,1	10"s.5	NW 273,0		286,1	276,0	14,0	20411850
319,0	12"		300	319,0	309,0	14,0	20411900
338,0	12"s.5	NW 323,9		338,0	328,0	14,0	20411950



info@iq-parts.nl
Harsweg 34A
2461 EZ Ter Aar
T +31 252 624 126
The Netherlands