

iQ parts
IQ-PARTS-SHOP.COM



**SPECS &
INFORMATION**

Blinddeckel/-flansch DIN32676 sched. A/B/C

Werkstoff: AISI 316L (1.4404)

Oberfläche: Hygieneklasse H3

Innen: <0,8 µm, Außen: <1,6 µm



EU Ware

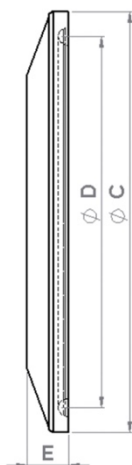

Passend zu Flansch Ø in mm	Rohrgrößen / Nennweiten			C mm	D mm	E mm	Item-No.
	DIN 32676 Reihe C / ISO 2852 / ASME BPE	DIN 32676 Reihe B / ISO 1127	DIN 32676 Reihe A				
25,0	1/4"-3/4"	NW 10,2-17,2	06-08	25,0	20,2	5,6	20401000
34,0			10-15-20	34,0	27,5	6,0	20401050
50,5	1"-1 1/2"	NW 21,3-33,7	25-32-40	50,5	43,5	7,0	20401100
64,0	2"	NW 42,4-48,3	50	64,0	56,5	7,0	20401150
77,5	2 1/2"	NW 60,3		77,5	70,5	7,0	20401200
91,0	3"	NW 76,1	65	91,0	83,5	7,0	20401250
106,0	3 1/2"	NW 88,9	80	106,0	97,0	7,0	20401300
119,0	4"		100	119,0	110,0	9,0	20401400
130,0		NW 114,3		130,0	122,0	9,0	20401450
144,4	5"			144,4	134,4	10,0	20401500
155,0		NW 139,7	125	155,0	146,0	10,0	20401550
167,0	6"			167,0	156,5	10,0	20401600
183,0		NW 168,3	150	183,0	174,0	10,0	20401650
217,4	8"			217,4	207,4	10,0	20401700
233,5	8 5/8"	NW 219,1	200	233,5	225,0	10,0	20401750
268,0	10"		250	268,0	258,0	10,0	20401800
286,1	10"s.5	NW 273,0		286,1	276,0	10,0	20401850
319,0	12"		300	319,0	309,0	10,0	20401900
338,0	12"s.5	NW 323,9		338,0	328,0	10,0	20401950



info@iq-parts.nl
Harsweg 34A
2461 EZ Ter Aar
T +31 252 624 126
The Netherlands