

**iQ parts**  
IQ-PARTS-SHOP.COM



**SPECS &  
INFORMATION**

# MINI HYBRID SERIES CONNECTOR

**Mini Hybrid Connector** – A compact, single connection point with a smaller form factor that is ideal for use in low-pressure applications where ease of use and ergonomics are important. This connector makes it easy to connect power, signal and gases in one simple motion.

## SPECIFICATIONS

**PRESSURE:**

Vacuum to 25 psi, 1.7 bar

**TEMPERATURE:**

40°F to 80°F (4°C to 27°C)

**MATERIALS:**

**External coupler components:** PET

**Air coupler components:** Acetal

**Springs:** Stainless steel

**Panel Mount Nut:** Zinc-plated steel

**Electrical contacts:** Gold-plated copper alloy

**O-rings:** Buna-N

**Air line:** PVC

**COLOR:** Gray

**EXTERNAL UMBILICAL HOSE:**

4 feet (121 cm) PVC

**WIRE:** 22AWG PVC jacket

**TERMINATIONS:**

**Panel:** 1/16" hose barb and two 22AWG wires with 11" pigtail

**Umbilical:** 4' (121 cm) umbilical with one 1/16" ID PVC tube and two 22AWG wires with 6" pigtail

**Number of air lines:** 1

**ELECTRICAL SPECIFICATIONS**

**Voltage:** Up to 24VDC

**Current:** Up to 3 Amps

**Wire:** 22AWG with PVC jacket

**Number of contacts:** 2



[cpcworldwide.com/MiniHybrid](http://cpcworldwide.com/MiniHybrid)

**FEATURES**

Easy-to-use breakaway design →

Small package design →

Streamlined exterior →

Proven design →

**BENEFITS**

Quick, automatic disconnect

Minimize device size

Clean, attractive appearance

Accelerate product development

## MINI HYBRID SERIES DIMENSIONS

**COUPLING HOSE - Acetal**



CONFIGURATION	FLOW PATHS	PART NO.	A	B
HOSE	1/16" ID (1.6mm)	MHQC17000	0.62 (15.7)	2 (50.8)

**COUPLING PANEL - Acetal**



CONFIGURATION	FLOW PATHS	PART NO.	A	B
PANEL MOUNT	1/16" ID (1.6mm)	MHQC42000	1 (25.4)	0.60 (15.2)

**PRODUCT DIMENSIONS**

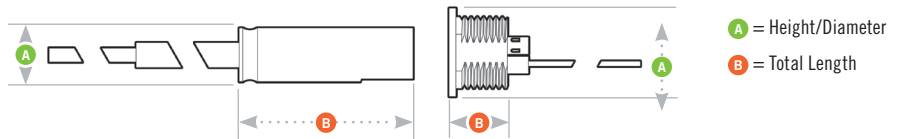

**PANEL DIMENSIONS**

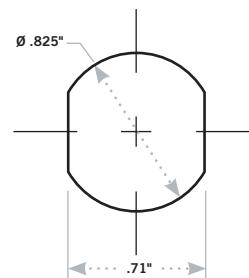





info@iq-parts.nl  
Harsweg 34A  
2461 EZ Ter Aar  
T +31 252 624 126  
The Netherlands